

- TITAN LX regulator -

First stage : In-line balanced diaphragm mechanism

Maximum service pressure : 300 bar DIN version ; 232 bar yoke version
4 outlets MP 3/8 UNF
1 outlet HP 7/16 UNF
Medium Pressure : 9.5 bar \pm 0.5 bar

Flow rate : 1400 l/min with HP = 200 bar

Body made of brass with satin chrome
Removable crown, spring : stainless steel
Conical filter : bronze with nickel coating
O-ring : EPDM



2nd stage : pneumatically balanced second stage

Cracking effort : between 2 to 4 mbar
Venturi effect tuning
Box bottom : made of A.B.S
Cover : Polyurethane
Mouthpiece, exhaust valve, seat, diaphragm : silicone
Adjustable crown : made of brass with chrome



MP hose : Length : 730 \pm 5 mm

Yoke Titan weight : 1105 g
DIN HP weight : 630 g

DIN Titan weight : 965 g
2nd stage weight : 175 g

Yoke HP weight : 770 g

Certification : EN250 :2000 regulator for cold water.

Breathing Performances :

Work of breathing (average) **W = 0,74 J/litre a**
RMV : 62.5 l/min, Depth : 50 m, HP = 50 bar.

Work of breathing (average) **W = 1,41 J/litre at**
RMV : 62.5 l/min, Depth : 80 m, HP = 50 bar.

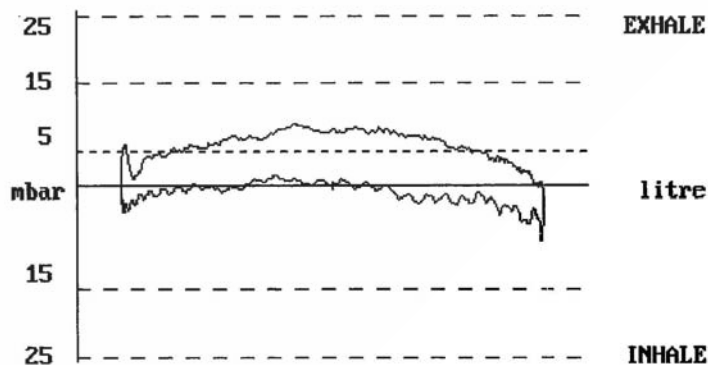

Products & kits references :

Yoke Titan LX : 129390
DIN Titan LX : 129380
Yoke Titan first stage : 103111
DIN Titan first stage : 103151
Titan LX second stage : 129325
MP hose : 124567

Service Kit Din / yoke first stage : 128002
Service Kit second stage : 129007
Service Kit Titan (1st & 2nd) : 129006
Conversion Kit yoke / Din : 128012

Comfo-bite mouthpiece (patent) fix with a removable clamp :

- Reduces the tiredness of the jawbones muscles,
- Quick change for disinfection operations.

Cover in Polyurethane :

- High resistance to abrasion and to tear
- Impact protection of the second stage
- Easy purge of the regulator

Versatile design allows a good gripping of the second stage

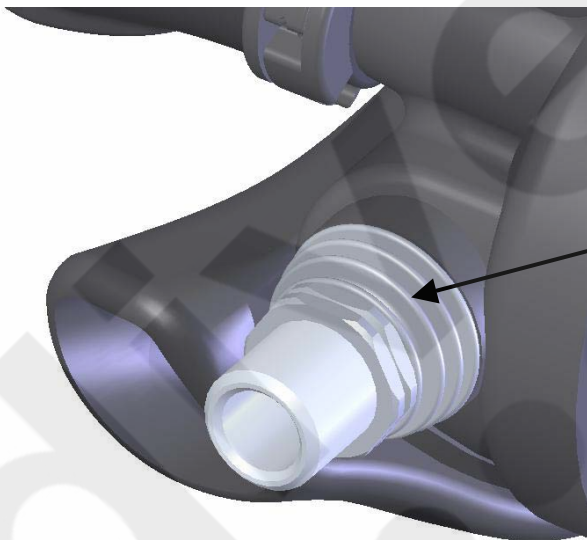
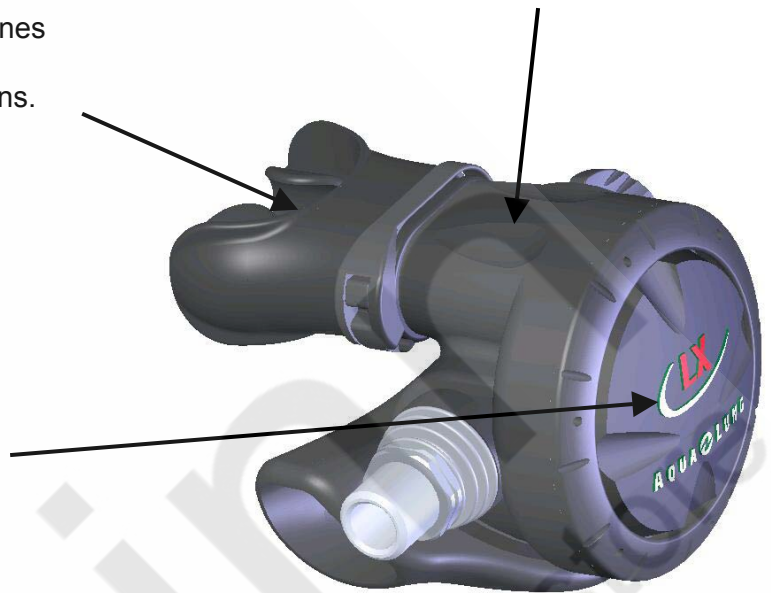

Heat exchangers :

Allows the evacuation of the negative kilocalories due to the air expansion (patent)

Venturi Adjustment Switch V.A.S. :

Reduces the sensitivity to free flow on the surface and provide maximum gas flow at depth.



Flow deflector in the inhale pipe :

Air flow evenly lead during inhalation.

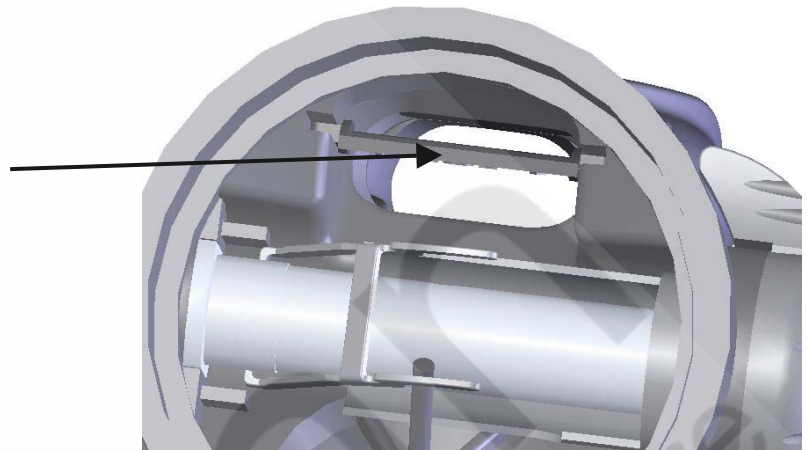

Benefits

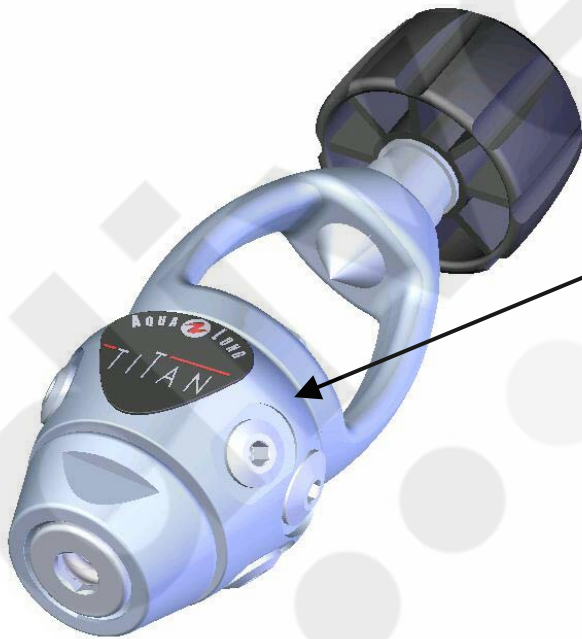

MP and HP outlets perfectly positioned allow an ideal orientation of the hoses.